



- ▶ **Very compact size**
- ▶ **Mould-proof housing**
- ▶ **Excellent thermal conduction characteristics due to homogenous constructional size**
- ▶ **Good temperature sensitivity**
- ▶ **Fast response time**

Area of application

The temperature detector P is used wherever protection against overtemperature is required. Specific applications include: protection of primary windings in transformers, winding protection in small electric motors, and general temperature protection of small electric equipments.

Function

The temperature detector P operates independent from any current supply. Temperature detection is effected by means of a bimetal disk which was first

dimensioned in accordance with the required cut-off temperature T_A . When this fixed cut-off temperature T_A is reached, this bimetal disk will snap over, breaking a contact system and thereby interrupting the electric circuit of the device to be protected.

After cooling down and reaching the closing temperature T_E , the bimetal disk will automatically return into its original position and make the contact. The electric circuit is closed again.

Technical specifications

Breaking capacity	250 V 2.5 A (1.6 A inductive)
Min. current	20 mA
Switching temperature	40 °C - 150 °C (±5 or 10) in 5 Kelvin steps
Max. breaking capacity	2,5A cos Φ 1,00 / 250 V, 150 °C
Switching differential	10K - 60 K depending on the cut-off temperature
Type of action	2. C
Max. ambient temperature	160 °C / 200 °C, 1 minute
Approvals	VDE (EN 60730) UL 2111, conform to RoHS

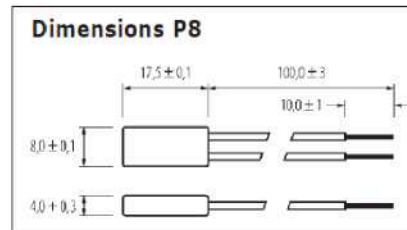

alternativ:

P5 housing type:

L 4,0 x W 8,0 x H 16,0

P1 housing type:*

L 3,6 x W 8,0 x H 14,5

*Use with mounting bracket 506 000

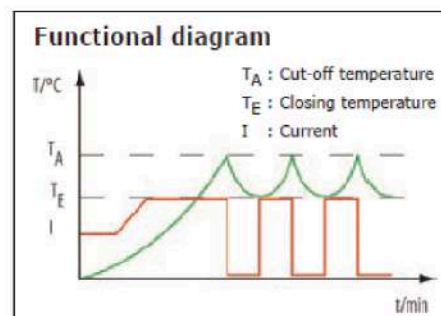
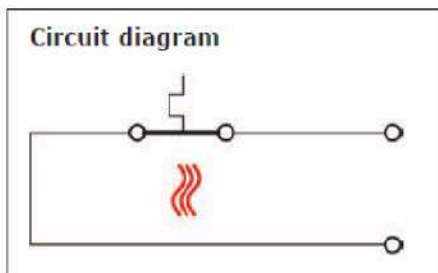



Technical data

All housing types are voltage-free. Due to its constructional size the P switch is one of the most compact thermostats available. This ensures a very fast response rate.

Its rectangular homogenous constructional size provides excellent thermal conduction characteristics.

Accessories

Mounting brackets 506005

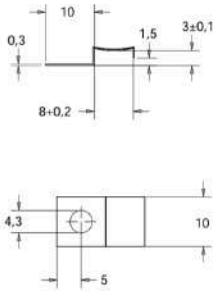

Mounting brackets

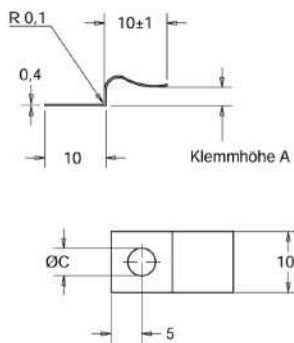

Part Nr.	Name	A	Ø C
506 003	KL 0350 0430	3,5mm	4,3mm
506 002	KL 0350 0350	3,5mm	3,5mm
506 001*	KL 0250 0430	2,2mm	4,3mm
506 000*	KL 0250 0350	2,2mm	3,5mm

* Exclusively suitable for housing type "1"



U-Clip 506100

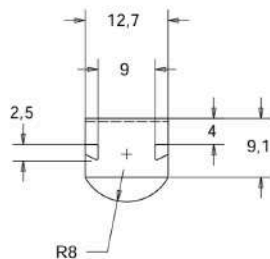
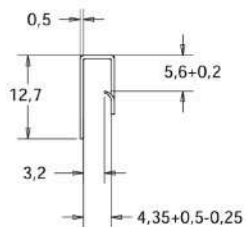

U-Clip 506101

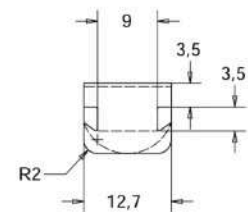
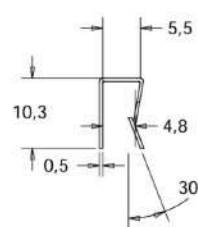



Ordering information (Please use the characters in the chart below to construct your product code)

Sample code P - 8 2 - 125 - 10 - 100 - 10A

Housing

- 0 Semi-Enclosure

- 1 PCB-Version

- 5 Unsealed housing

- 8 Sealed housing (Standard)

Electrical connections

- 1 Bare solid wire AWG 24

- 2 Stranded wire double tinned AWG 24 (Standard)

- 3 Insulated solid wire AWG 24

- 4 Bare solid wire AWG 22

- 5 Stranded wire AWG 24

- 6 Insulated solid wire AWG 22

- 7 Stranded wire AWG 22

- 9 Stranded wire AWG20 or customized electrical connections

Operating Temperature

Temperature range 40°C - 150°C
Selectable in 5° steps

e.g.:
120 120°C

Tolerance Operating Temperature

- 05 ± 5 Kelvin (Standard)

- 10 ± 10 Kelvin (Standard for 150°C switches)

Lead Wire Length

- 100 100mm (Standard)
- 3 - 9999 mm

Lead specification

Only with connection option "stranded wire"

10 mm	(Standard)	A	Fully stripped (Standard)
Other lengths upon request		HA	Half stripped